

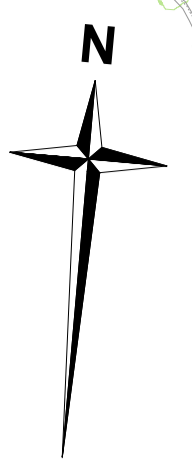

- Notes**
1. Shape and size of borrow pits could change. For all proposed planting details refer to Environmental Statement Figure 2.4 Indicative Landscape and Environmental Design.
 2. Roundabouts and their approaches proposed to be street lit.
 3. 50mph speed limit proposed along Link Road.
 4. Maintenance tracks and earthworks around attenuation ponds are not shown.

- Legend**
- Planning Application Boundary
 - Proposed swales
 - Proposed ditches
 - - - Proposed post and rail fencing
 - Proposed close boarded fencing
 - Proposed anti-glare barrier
 - Existing Footpath
 - - - Existing Restricted Byway
 - - - Public Right of Way to be diverted
 - Proposed carriageway
 - Proposed traffic islands
 - Proposed verge
 - Proposed planting and seeding (See note 1)
 - Proposed maintenance track / field access
 - Proposed segregated footway/cycleway
 - Proposed unsegregated footway/cycleway
 - Proposed footway
 - Proposed Public Right of Way
 - Indicative borrow pits and associated landscaping (BP1 BP3, BP4 and BP5; see note 1)
 - Proposed attenuation ponds (1 to 11)
 - Proposed trees
 - Existing trees, hedges and shrubs to be retained

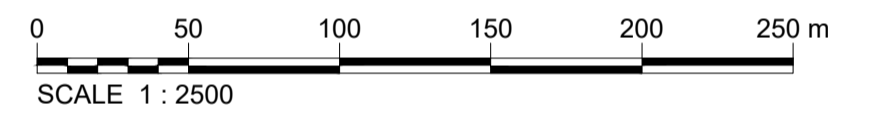

CUTLINE A

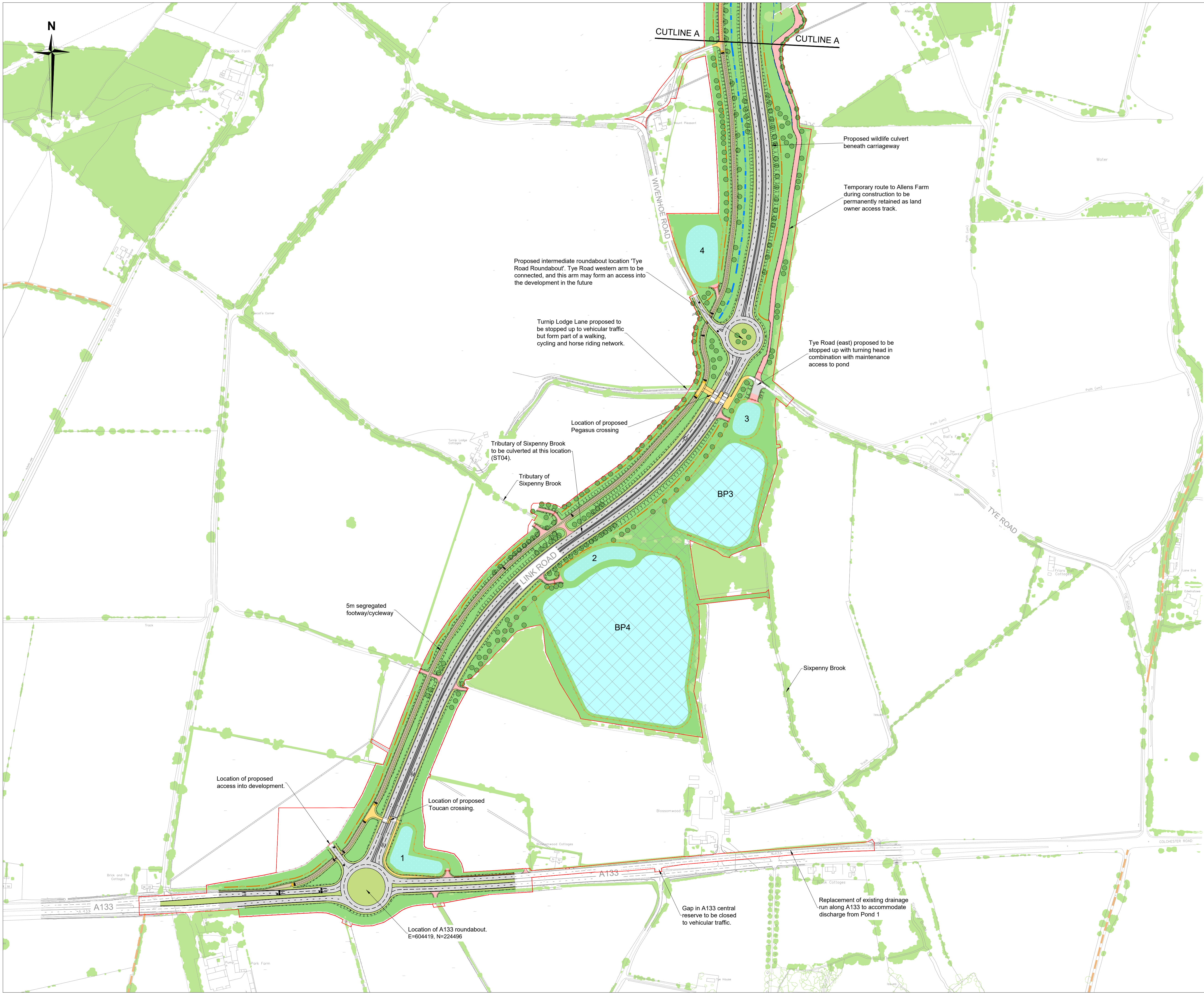

- Notes**
1. Shape and size of borrow pits could change. For all proposed planting details refer to Environmental Statement Figure 2.4 Indicative Landscape and Environmental Design.
 2. Roundabouts and their approaches proposed to be street lit.
 3. 50mph speed limit proposed along Link Road.
 4. Maintenance tracks and earthworks around attenuation ponds are not shown.

- Legend**
- Planning Application Boundary
 - Proposed swales
 - Proposed ditches
 - Proposed post and rail fencing
 - Proposed close boarded fencing
 - Proposed anti-glare barrier
 - Existing Footpath
 - Existing Restricted Byway
 - Public Right of Way to be diverted
 - Proposed carriageway
 - Proposed traffic islands
 - Proposed verge
 - Proposed planting and seeding (See note 1)
 - Proposed maintenance track / field access
 - Proposed segregated footway/cycleway
 - Proposed unsegregated footway/cycleway
 - Proposed footway
 - Proposed Public Right of Way
 - Indicative borrow pits and associated landscaping (BP1 BP3, BP4 and BP5; see note 1)
 - Proposed attenuation ponds (1 to 11)
 - Proposed trees
 - Existing trees, hedges and shrubs to be retained

